

BDPG-28-38 Series



- DC Brush GearMotor
- Designed for high volume applications
- Up to 70 g-cm of Torque
- 28 mm motor body diameter

BDPG-28-38-12V-3000-Rxx Specifications

Gear Ratio	4	5	14	19	27	51	71	100	139	189	265	369	516	720
Length (L) (mm)	38	38	38	38	38	44	44	44	44	50	50	50	50	50
No Load Speed (RPM)	750	600	214	157	111	58	42	30	21	15	11	8	6	4
Rated Speed (RPM)	625	500	178	131	92	49	35	25	18	13	9	6	5	3
Rated Torque(kg-cm)	0.1	0.2	0.5	0.7	1.1	1.8	2.5	3.6	4.9	5.7	8.0	10	10	10
Rotation Direction	CCW	CCW	CW	CW	CW	CCW	CCW	CCW	CCW	CW	CW	CW	CW	CW

BDPG-28-38-12V-4000-Rxx Specifications

Gear Ratio	4	5	14	19	27	51	71	100	139	189	265	369	516	720
Length (L) (mm)	38	38	38	38	38	44	44	44	44	50	50	50	50	50
No Load Speed (RPM)	1000	800	285	210	148	78	56	40	28	21	15	10	7	5
Rated Speed (RPM)	750	600	214	157	111	58	42	30	21	15	11	8	6	4
Rated Torque (kg-cm)	0.2	0.3	0.7	0.9	1.3	2.3	3.2	4.5	6.3	7.2	10	10	10	10
Rotation Direction	CCW	CCW	CW	CW	CW	CCW	CCW	CCW	CCW	CW	CW	CW	CW	CW

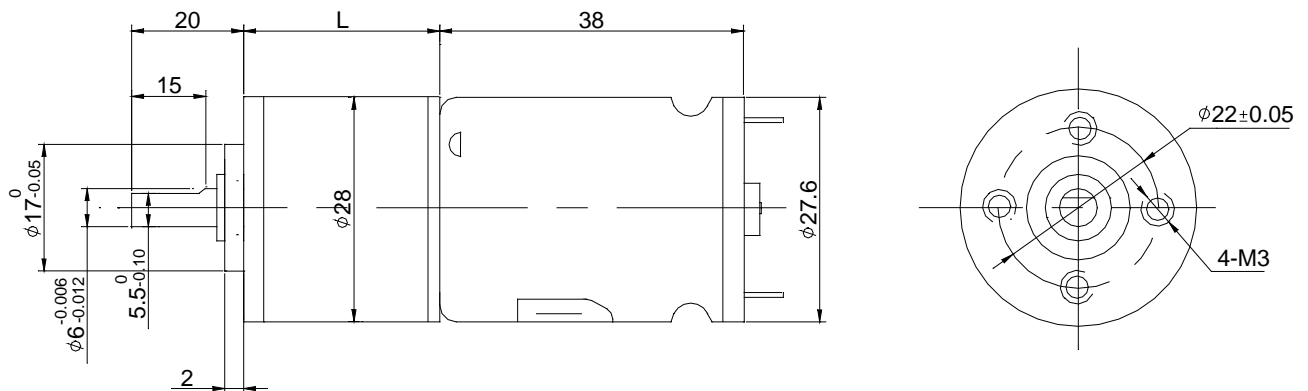

Doc#L010336